

SPECIFICATIONS:

ECONOMY—EECF2-Series: 400 Series Stainless Top, 400 Series Stainless Body & 400 Series Stainless Undershelf

TOP: 16 GA.
400 Series Stainless
SHELF: 18 GA.
400 Series Stainless
BODY: 20 GA.
400 Series Stainless
LEGS: 1 1/2" Square
Tubular Stainless Steel

STANDARD—SECF2-Series: 300 Series Stainless Top, 300 Series Stainless Body & 300 Series Stainless Undershelf

TOP: 16 GA.
300 Series Stainless
SHELF: 18 GA.
300 Series Stainless
BODY: 20 GA.
300 Series Stainless
LEGS: 1 1/2" Square
Tubular Stainless Steel

HEAVY DUTY—HECF2-Series: 300 Series Stainless Top, 300 Series Stainless Body & 300 Series Stainless Undershelf

TOP: 14 GA.
300 Series Stainless
SHELF: 16 GA.
300 Series Stainless
BODY: 18 GA.
300 Series Stainless
LEGS: 1 1/2" Square
Tubular Stainless Steel

CONSTRUCTION:

- ◆ All Table Connection Points Fully Welded for Maximum Rigidity and Long Life
- ◆ Sound Deadening Between Top and Reinforcing Channel
- ◆ Offsets on Body Ends for Flush Fit
- ◆ S/S Undershelf Welded to Legs
- ◆ Table is Polished to #3 Finish
- ◆ Working Height 35" to 36 1/4"
- ◆ Casters Rated at 250 Lbs. Each.



○ Amtekco Industries - Columbus, OH —Phone: (800) 336-4677

○ N. Wasserstrom & Sons - Columbus, OH —Phone: (800) 444-4697

○ DCS IV - Peoria, AZ—Phone: (800) 592-3274

○ GEN III - Fountain Inn, SC—Phone: (800)673-3339

○ GKS - Garland, TX—Phone (972) 485-4579

SPECIFICATIONS SUBJECT TO CHANGE WITHOUT NOTICE 01/09

STAINLESS STEEL WORKTABLES

EECF2-SERIES— ENCLOSED WORKTABLE W/ BACKSPLASH, UNDERSHELF & CASTERS

PROJECT#: _____

ITEM# _____

MODEL# _____

ECONOMY - EECF2 - SERIES						
24" WIDE	QTY	30" WIDE	QTY	36" WIDE	QTY	LENGTH (INCHES)
EECF2-2424		EECF2-3024		EECF2-3624		24
EECF2-2430		EECF2-3030		EECF2-3630		30
EECF2-2436		EECF2-3036		EECF2-3636		36
EECF2-2442		EECF2-3042		EECF2-3642		42
EECF2-2448		EECF2-3048		EECF2-3648		48
EECF2-2454		EECF2-3054		EECF2-3654		54
EECF2-2460		EECF2-3060		EECF2-3660		60
EECF2-2466		EECF2-3066		EECF2-3666		66
EECF2-2472		EECF2-3072		EECF2-3672		72
EECF2-2478		EECF2-3078		EECF2-3678		78
EECF2-2484		EECF2-3084		EECF2-3684		84
EECF2-2490		EECF2-3090		EECF2-3690		90
EECF2-2496		EECF2-3096		EECF2-3696		96
EECF2-24102		EECF2-30102		EECF2-36102		102
EECF2-24108		EECF2-30108		EECF2-36108		108
EECF2-24114		EECF2-30114		EECF2-36114		114
EECF2-24120		EECF2-30120		EECF2-36120		120
STANDARD - SECF2 - SERIES						
24" WIDE	QTY	30" WIDE	QTY	36" WIDE	QTY	LENGTH (INCHES)
SECF2-2424		SECF2-3024		SECF2-3624		24
SECF2-2430		SECF2-3030		SECF2-3630		30
SECF2-2436		SECF2-3036		SECF2-3636		36
SECF2-2442		SECF2-3042		SECF2-3642		42
SECF2-2448		SECF2-3048		SECF2-3648		48
SECF2-2454		SECF2-3054		SECF2-3654		54
SECF2-2460		SECF2-3060		SECF2-3660		60
SECF2-2466		SECF2-3066		SECF2-3666		66
SECF2-2472		SECF2-3072		SECF2-3672		72
SECF2-2478		SECF2-3078		SECF2-3678		78
SECF2-2484		SECF2-3084		SECF2-3684		84
SECF2-2490		SECF2-3090		SECF2-3690		90
SECF2-2496		SECF2-3096		SECF2-3696		96
SECF2-24102		SECF2-30102		SECF2-36102		102
SECF2-24108		SECF2-30108		SECF2-36108		108
SECF2-24114		SECF2-30114		SECF2-36114		114
SECF2-24120		SECF2-30120		SECF2-36120		120
HEAVY DUTY - HECF2 - SERIES						
24" WIDE	QTY	30" WIDE	QTY	36" WIDE	QTY	LENGTH (INCHES)
HECF2-2424		HECF2-3024		HECF2-3624		24
HECF2-2430		HECF2-3030		HECF2-3630		30
HECF2-2436		HECF2-3036		HECF2-3636		36
HECF2-2442		HECF2-3042		HECF2-3642		42
HECF2-2448		HECF2-3048		HECF2-3648		48
HECF2-2454		HECF2-3054		HECF2-3654		54
HECF2-2460		HECF2-3060		HECF2-3660		60
HECF2-2466		HECF2-3066		HECF2-3666		66
HECF2-2472		HECF2-3072		HECF2-3672		72
HECF2-2478		HECF2-3078		HECF2-3678		78
HECF2-2484		HECF2-3084		HECF2-3684		84
HECF2-2490		HECF2-3090		HECF2-3690		90
HECF2-2496		HECF2-3096		HECF2-3696		96
HECF2-24102		HECF2-30102		HECF2-36102		102
HECF2-24108		HECF2-30108		HECF2-36108		108
HECF2-24114		HECF2-30114		HECF2-36114		114
HECF2-24120		HECF2-30120		HECF2-36120		120

STAINLESS STEEL WORKTABLES

ECF2-SERIES— ENCLOSED WORKTABLE W/ BACKSPLASH, UNDERSHELF & CASTERS

PROJECT#: _____

ITEM# _____

MODEL# _____

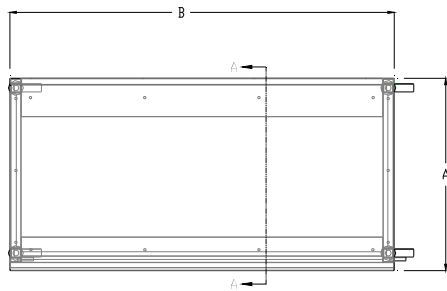

PLAN VIEW

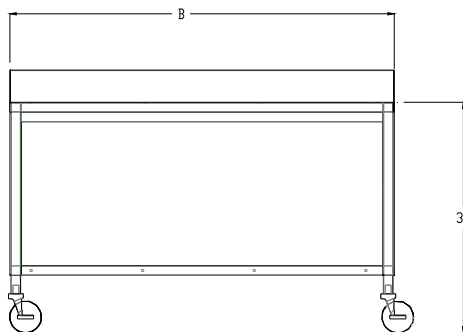

ELEVATION

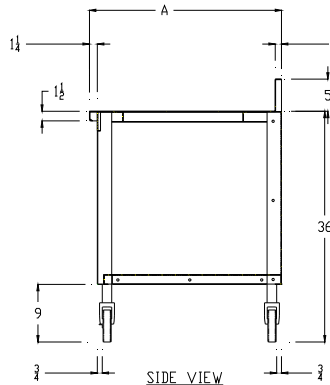

SIDE VIEW

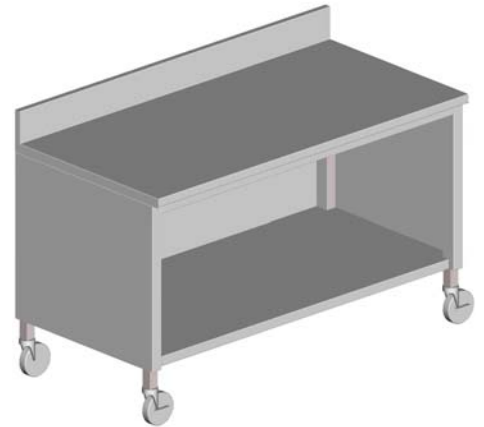

◆ Tables At or Above 78" Will Require (3) Sets of Legs.

A WIDTH	B LENGTH	EECF2 - SERIES 16 GA. 400 SERIES S/S TOP & 18 GA. 400 SERIES S/S UNDERSHELF	SECF2 - SERIES 16 GA. 300 SERIES S/S TOP & 18 GA. 300 SERIES S/S UNDERSHELF	HECF2 - SERIES 14 GA. 300 SERIES S/S TOP & 16 GA. 300 SERIES S/S UNDERSHELF	#Of Legs	Product Weight (lbs)
24" WIDE						
24	24	EECF2-2424	SECF2-2424	HECF2-2424	4	96
24	30	EECF2-2430	SECF2-2430	HECF2-2430	4	118
24	36	EECF2-2436	SECF2-2436	HECF2-2436	4	139
24	48	EECF2-2448	SECF2-2448	HECF2-2448	4	166
24	60	EECF2-2460	SECF2-2460	HECF2-2460	4	194
24	72	EECF2-2472	SECF2-2472	HECF2-2472	4	222
24	84	EECF2-2484	SECF2-2484	HECF2-2484	6	249
24	96	EECF2-2496	SECF2-2496	HECF2-2496	6	277
24	108	EECF2-24108	SECF2-24108	HECF2-24108	6	304
24	120	EECF2-24120	SECF2-24120	HECF2-24120	6	332
30" WIDE						
30	24	EECF2-3024	SECF2-3024	HECF2-3024	4	89
30	30	EECF2-3030	SECF2-3030	HECF2-3030	4	113
30	36	EECF2-3036	SECF2-3036	HECF2-3036	4	136
30	48	EECF2-3048	SECF2-3048	HECF2-3048	4	165
30	60	EECF2-3060	SECF2-3060	HECF2-3060	4	195
30	72	EECF2-3072	SECF2-3072	HECF2-3072	4	225
30	84	EECF2-3084	SECF2-3084	HECF2-3084	6	254
30	96	EECF2-3096	SECF2-3096	HECF2-3096	6	284
30	108	EECF2-30108	SECF2-30108	HECF2-30108	6	313
30	120	EECF2-30120	SECF2-30120	HECF2-30120	6	343
36" WIDE						
36	24	EECF2-3624	SECF2-3624	HECF2-3624	4	114
36	30	EECF2-3630	SECF2-3630	HECF2-3630	4	141
36	36	EECF2-3636	SECF2-3636	HECF2-3636	4	167
36	48	EECF2-3648	SECF2-3648	HECF2-3648	4	199
36	60	EECF2-3660	SECF2-3660	HECF2-3660	4	232
36	72	EECF2-3672	SECF2-3672	HECF2-3672	4	265
36	84	EECF2-3684	SECF2-3684	HECF2-3684	6	297
36	96	EECF2-3696	SECF2-3696	HECF2-3696	6	330
36	108	EECF2-36108	SECF2-36108	HECF2-36108	6	362
36	120	EECF2-36120	SECF2-36120	HECF2-36120	6	395